

UNO XTRA

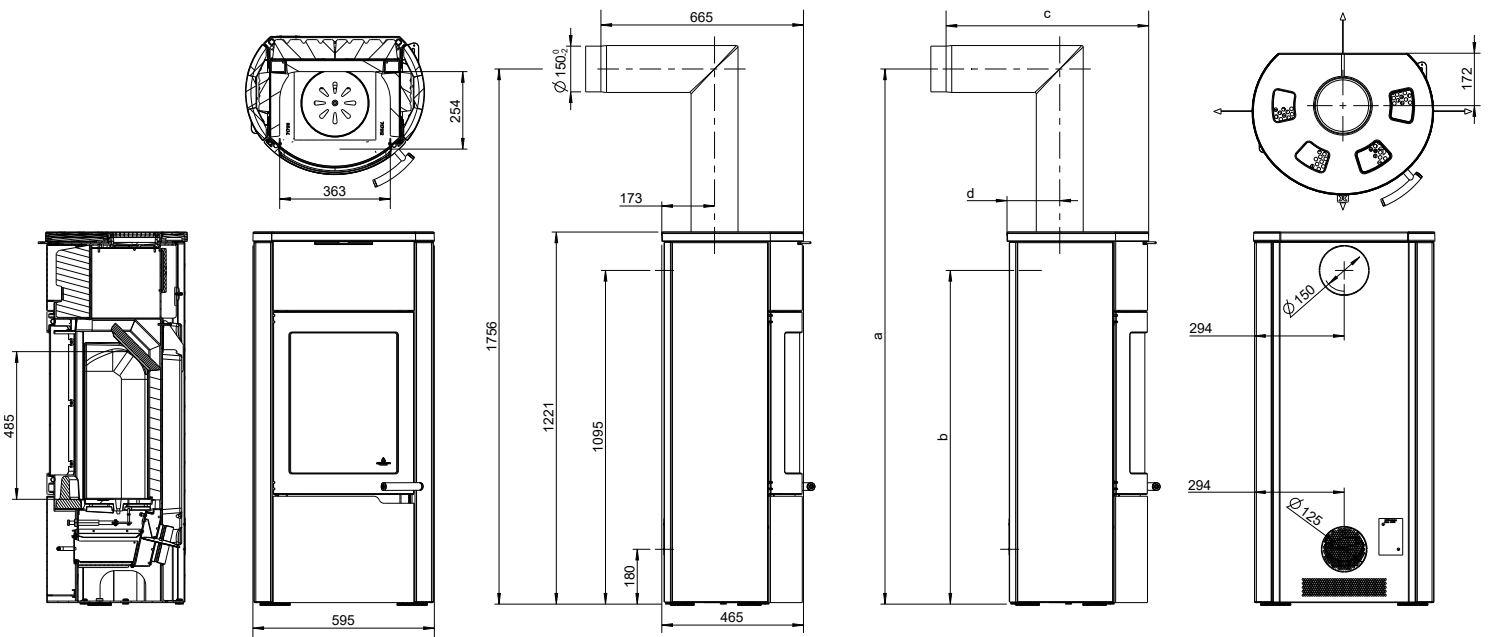

AUSTROFLAMM



www.austroflamm.com

Dimensions and weight	
Height [mm]	1221
Width [mm]	595
Depth [mm]	465
Combustion chamber width [mm]	363
Combustion chamber height [mm]	485
Combustion chamber depth [mm]	254
Baking compartment width [mm]	-
Baking compartment height [mm]	-
Baking compartment depth [mm]	-
Warming drawer, width [mm]	-
Warming compartment height [mm]	-
Warming drawer, depth [mm]	-
Dimensions, a (with Austroflamm elbow piece) [mm]	1756
Dimensions, b (with Austroflamm elbow piece) [mm]	1095
Dimensions, c (with Austroflamm elbow piece) [mm]	665
Dimensions, d (with Austroflamm elbow piece) [mm]	173
Flue pipe outlet, diameter [mm]	150
Outside air connection diameter [Ø mm]	125
Weight, basic appliance [kg]	245
Weight Xtra [kg]	114
Weight, HMS [kg]	-
Total weight inc. steel case (STM) [kg]	261
Total weight inc. ceramic case (KGM) [kg]	283
Total weight inc. soapstone case (SPM) [kg]	320
a: Safety distance to combustible materials, front [mm]	800
b: Safety distance to combustible materials, left [mm]	130
c: Safety distance to combustible materials, rear [mm]	150
d: Safety distance to combustible materials, right [mm]	130
Safety distance to combustible materials, floor [mm]	0
Minimum distance from non-flammable materials [mm]	50
Output	
Nominal heat efficiency [kW]	7.0
Minimum heat output [kW]	3.5
Maximum heat output [kW]	9.0
Minimum room heating capacity [m³]	82
Maximum room heating capacity [m³]	210
Energy efficiency class	A
Data for the chimney sweep	
Exhaust gas mass flow [g/s]	6.5
Flue gas temperature [°C]	300
Minimum delivery pressure at nominal heat output [Pa]	12
at 0.8 times nominal heat output [Pa]	10
Equipment	
Xtra heat storage technology	Standard
Heat Memory System	-
External air connection / operation independent of ambient air	Yes
Ash removal	Ash pan

- not available